



AUTO-BURN™

ICE BIN

INSTALLATION & OPERATION GUIDE



READ THIS MANUAL BEFORE OPERATING!

- *Installation by licensed plumber is recommended.*
- *Always follow appropriate plumbing code.*

SAFETY

- USE AUTO-BURN™ ONLY AS INSTRUCTED IN THIS MANUAL.
- THIS MANUAL DOES NOT COVER EVERY POSSIBLE CONDITION AND SITUATION THAT MAY OCCUR. USE COMMON SENSE AND CAUTION WHEN INSTALLING, OPERATING, AND MAINTAINING THIS DEVICE.
- CLOGGED ICE BIN DRAIN LINES AND FLOOR SINKS/DRAINS MAY CAUSE FLOODING. MAINTAIN ICE BIN DRAIN LINES AND FLOOR SINKS/DRAINS TO AVOID FLOODING.
- ALWAYS INSTALL SECONDARY SHUTOFF VALVE (F) IN ADDITION TO PRIMARY CONTROL VALVE (G). FAILURE TO DO SO VOIDS WARRANTY.
- WATER STREAM FROM AUTO-BURN™ IS HOT! DIRECT CONTACT WITH WATER STREAM MAY CAUSE SCALDING!
- AUTO-BURN™ IS NOT INTENDED TO BE A SUBSTITUTE FOR WASHING, DRYING, & SANITIZING ICE BINS. FOLLOW PROPER HEALTH CODE PROCEDURES. REGULARLY WASH & SANITIZE ICE BINS.
- MISUSE MAY CAUSE FLOODING OR WATER DAMAGE! ENSURE THAT VALVE IS TURNED COMPLETELY OFF AFTER USE!

1 Assembly

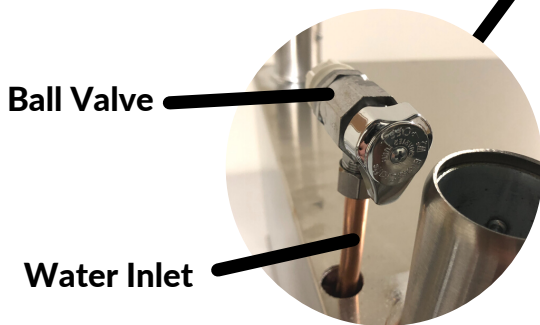
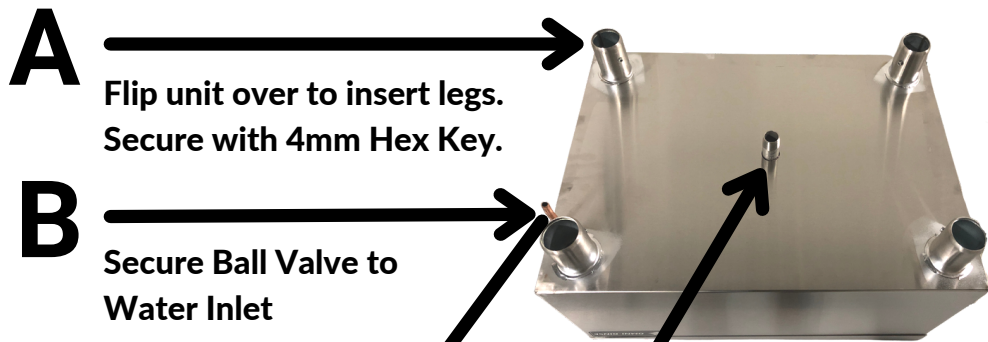

C  Attach appropriate drain
connector to 1" OD drain fitting



D  Adjust feet to stabilize and level unit

E Proceed to sections 2 and 3 for directions on connecting
ice bin to hot water with included Installation Kit.

2

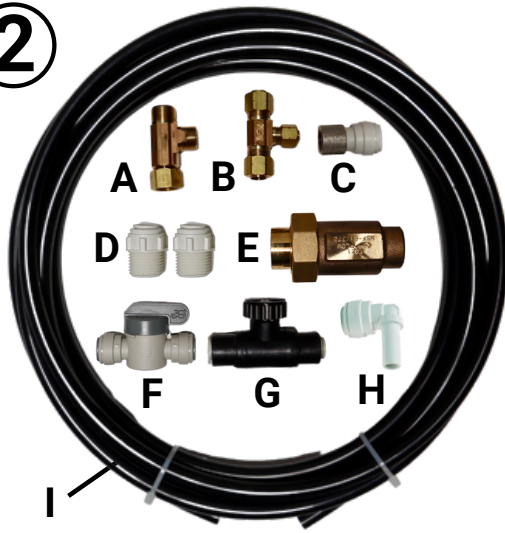

Installation Kit Parts List

- A. 3/8 Adapter Tee
- B. 3/8 Compression Tee
- C. 3/8 Push-Fit Adapter
- D. (2) Male Push-Fit Adapters (Saddle Mount Unit and Ice Bin ONLY)
- E. Backflow Preventer (Saddle Mount Unit and Ice Bin ONLY)
- F. Inline Shutoff Valve
- G. Control Valve (style varies with ice bin)
- H. Plug Elbow (Backsplash Mount ONLY)
- I. 3/8 LLDPE Tubing

* H not included with AB-CH1 or AB-IB1
 ** D and E not included with AB-BSM1

NEEDED FOR INSTALLATION:

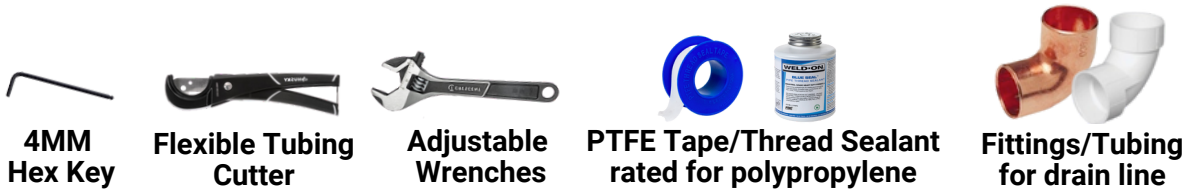

3 Auto-Burn™ Plumbing Installation Diagram

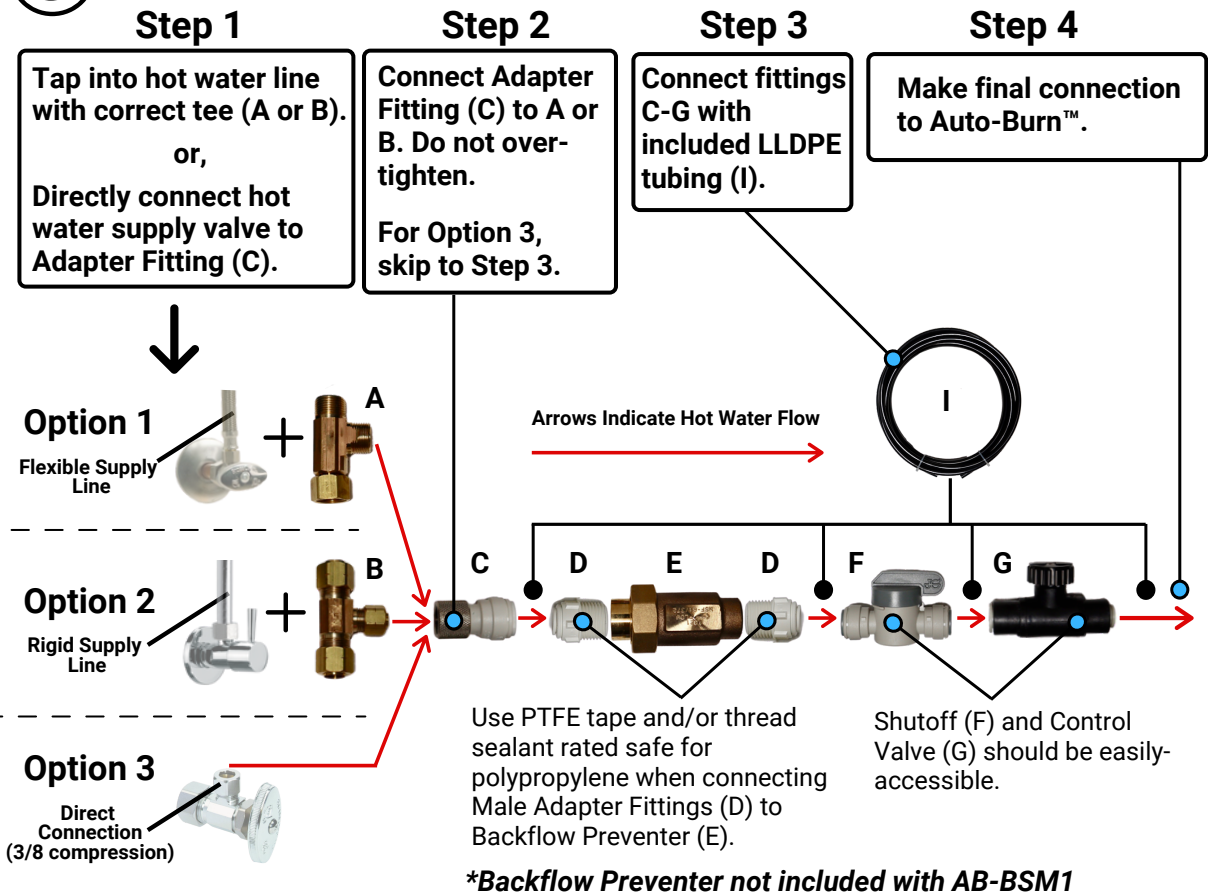

TESTING

1. Turn Control Valve (G) counterclockwise to turn water on--adjust stream accordingly.
2. Ensure ice bin and floor sink/drain are properly draining water.
3. Test Shutoff Valve (F) by turning it off and back on.
4. Turn Control Valve (G) clockwise to OFF position and confirm that it is not leaking.
5. Installation is now complete. Deliver this Operation Guide to customer.

OPERATION INSTRUCTIONS

(Refer to Plumbing Installation Diagram)

1. Turn Control Valve (G) counterclockwise to turn Auto-Burn™ Head on. Make fine adjustments for desired flow. **WATER FLOW MAY BE STRONG, SO ADJUST ACCORDINGLY! WATER IS HOT! DIRECT CONTACT WITH WATER STREAM MAY CAUSE SCALDING! USE CAUTION AND COMMON SENSE AT ALL TIMES!**
2. After use, turn Control Valve (G) clockwise to OFF position.
3. After ice has melted, confirm that all debris or foreign objects have been removed by **COMPLETELY DRYING ICE BIN WITH A CLEAN SQUEEGEE AND/OR TOWEL!**
4. **AUTO-BURNING™ ICE IS NOT A SUBSTITUTE FOR WASHING, RINSING, SANITIZING, & DRYING ICE BINS.**
5. **WARNING: FLOODING MAY OCCUR IF DRAIN LINES ARE CLOGGED!**
6. Use Auto-Burn™ daily to help keep ice bins clean and free of harmful debris and contaminants.
7. If Control Valve (G) fails, turn unit off with Shutoff Valve (F) to replace Control Valve.

Visit OmniRinse.com for more information